

WIN-WIN AND INNOVATION

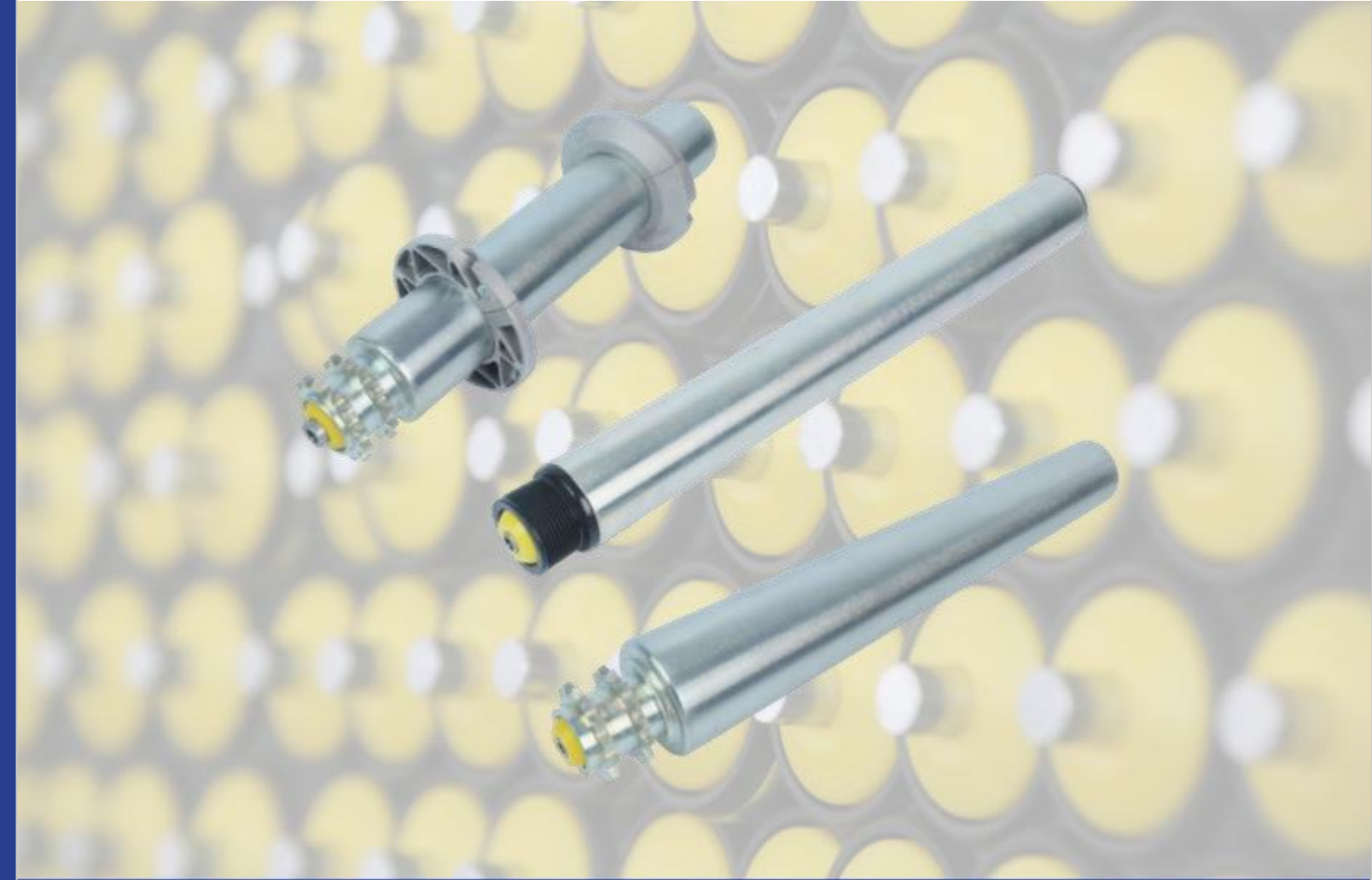

产品选购手册

PRODUCT SELECTION GUIDE

青岛搜逅智能科技有限公司

Qingdao Ssohou intelligent Technology Co., LTD

Tel: 13325001090

Whatsapp/Wechat:+86 13325001090

Web: www.ssohou.com

Email: sales@ssohou.com

Add:Xijiao Industrial Park, HuanXiu?Street, Jimo District,?Qingdao, Shandong Province, China.



CORPORATE INTRODUCTION

Win-win And Innovation

Qingdao Ssouhou intelligent Technology Co., LTD., established in 2018, specializes in the research, development, and manufacturing of intelligent logistics equipment and key components such as rollers. We provide intelligent equipment solutions.

The company adheres to independent innovation, continuously developing intelligent logistics equipment software and hardware technologies. Over the past three years, our R&D investment has reached 8% of our revenue. We own 36 independent intellectual property rights, including 2 invention patents and 4 software copyrights, which have been widely recognized in both domestic and international markets. Currently, 23% of our employees hold a bachelor's degree or higher, and 52% have an associate degree or higher. Additionally, we continuously invest in intelligent professional equipment, introducing management systems such as EPR, APS, MES, and PLM to accelerate the company's digital transformation and upgrade, striving to build an intelligent digital factory.

Adhering to the business philosophy of "win-win and innovation," the company is committed to becoming a globally leading supplier of professional intelligent equipment components, promoting the high-quality development of intelligent equipment to new heights.

CORPORATE CULTURE 企业文化

Corporate Vision

企业愿景

打造成为全球领先的专业智能装备领域组件供应商
To become a leading global component supplier in the field of professional intelligent equipment

Business Philosophy

经营理念

共赢而生 创新而行
Win-win and innovation

Enterprise Mission

企业使命

为顾客创造价值，为员工创造前途，为社会创造贡献
Create value for customers, create future for employees and contribute to society.



BUSINESS PARTNER 合作伙伴



TABLE OF CONTENTS

01 | Power Roller Series 05-10

02 | Conveyor Roller Series

1001 Gravity Conveyor Roller with Steel Bearing Housing	11
1002 Gravity Conveyor Roller with Polymer Bearing Housing	12
1011/1021 Single/Double Groove O-Belt Roller with Steel Bearing Housing	13
1012/1022 Single/Double Groove O-Belt Roller with Polymer Bearing Housing	14
2031 Polymer Poly-V Conveyor Roller	15
2051 Polymer O-Belt Conveyor Roller	16
2021/2022 Polymer Sprocket Conveyor Roller	17
2011/2012 Steel Single/Double Sprocket Conveyor Roller	18
2013 Steel Double Sprocket Conveyor Roller with Flange	18
3011/3012 Polymer Single/Double Sprocket Friction Accumulating Roller	19
3021/3022 Steel Single/Double Sprocket Friction Accumulating Roller	20
3031/3032 Steel Single/Double Sprocket Adjustable Accumulating Roller	21
4001 Gravity Tapered Sleeve Roller	22
4012/4022 Single/Double Groove O-Belt Tapered Sleeve Roller	23
4034 Polymer Poly-V Tapered Sleeve Roller	24
4024 Polymer O-Belt Tapered Sleeve Roller	25
4014/4015 Polymer Sprocket Tapered Sleeve Roller	26
4002 Gravity Steel Tapered Roller	27
4004/4005 Steel Single/Double Sprocket Tapered Roller	27

03 | Roller Series for Belt 28

04 | Conveyor System 29-30



- Drives essential units to easily achieve decentralized control, saves power and energy.
- A variety of power choices, providing the optimal option according to actual needs.
- Speed adjustment can be easily achieved using specialized control card.
- Constant-speed conveying through signal feedback

Product Configuration

Gear Ratio	max. Conveying Speed (m/min)	35W(24V)		50W(24V)		70W(24V)		100W(48V)	
		Starting Torque (Nm)	max. Torque (Nm)	Starting Torque (Nm)	max. Torque (Nm)	Starting Torque (Nm)	max. Torque (Nm)	Starting Torque (Nm)	max. Torque (Nm)
9:1	122.4	1.17	0.47	1.67	0.67	2.51	1.00	3.35	1.34
12:1	91.8	1.56	0.63	2.23	0.89	3.35	1.34	4.46	1.79
16:1	68.4	2.08	0.83	2.98	1.19	4.46	1.79	5.95	2.38
18:1	61.2	2.34	0.94	3.35	1.34	5.02	2.01	6.69	2.68
24:1	45.6	3.13	1.25	4.46	1.79	6.69	2.68	8.93	3.57
27:1	40.8	3.52	1.41	5.02	2.01	7.53	3.01	10.04	4.02
36:1	30.6	4.69	1.88	6.69	2.68	10.04	4.02	13.39	5.36
48:1	22.8	6.25	2.50	8.93	3.57	13.39	5.36	17.85	7.14
54:1	20.4	7.03	2.81	10.04	4.02	15.06	6.02	20.08	8.03
64:1	17.4	8.33	3.33	11.90	4.76	17.85	7.14	23.8	9.52
72:1	15	9.38	3.75	13.39	5.36	20.08	8.03	26.78	10.71
96:1	11.4	12.5	5.00	17.85	7.14	26.78	10.71	35.7	14.28
108:1	10.2	14.06	5.63	20.08	8.03	30.12	12.05	40.16	16.07
144:1	7.8	18.75	7.5	26.78	10.71	40.16	16.07	53.55	21.42
216:1	4.8	28.13	11.25	40.16	16.07	60.24	24.10	80.33	32.13

Product Code

ZYDM - 50 - 70 - 016 AVA - E - W

① ② ③ ④ ⑤ ⑥ ⑦ ⑧

① Diameter: 50mm

② Power: 35W, 50W, 70W, 100W

③ Gear Ratio

④ Tube Material: A-galvanized, S-304 stainless steel, P-2mm PVC polyethylene, Q-2mm natural rubber, N-5mm PVC

⑤ Driving method: A-straight tube, V-Poly-V, S-double sprocket, P-timing belt, G-grooved, F-O belt

⑥ Installation method: A-spring loaded, T-internal thread

⑦ Internal/External Drive: I-internal drive, E-external drive

⑧ Roller Surface Length

Straight Tube

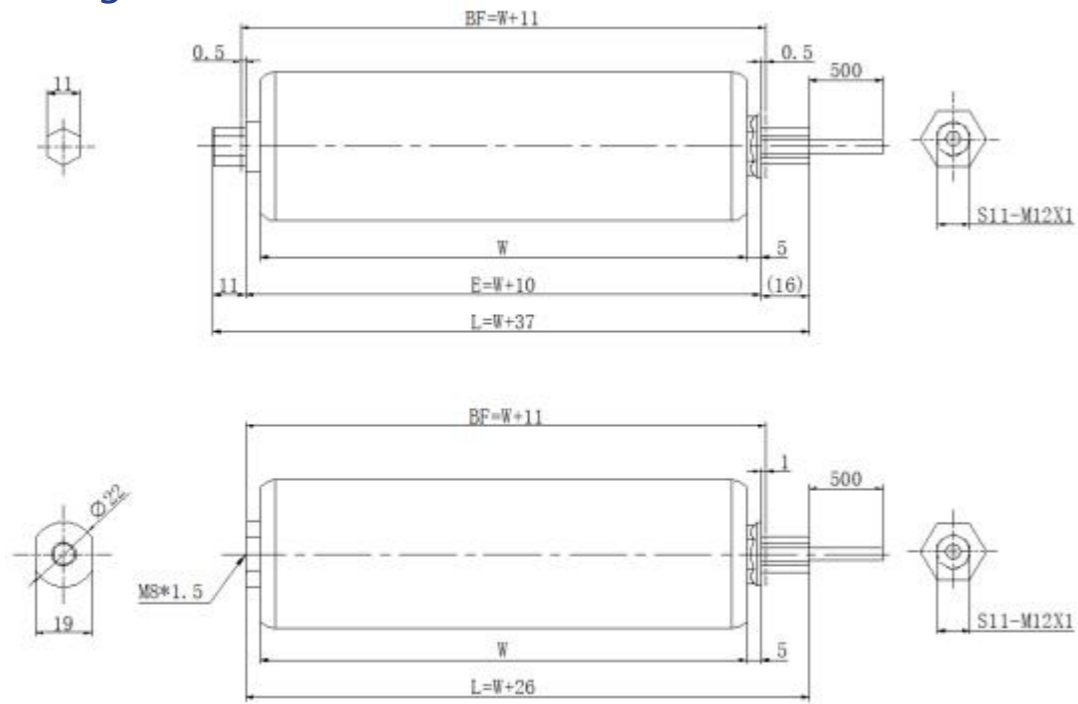

Grooved

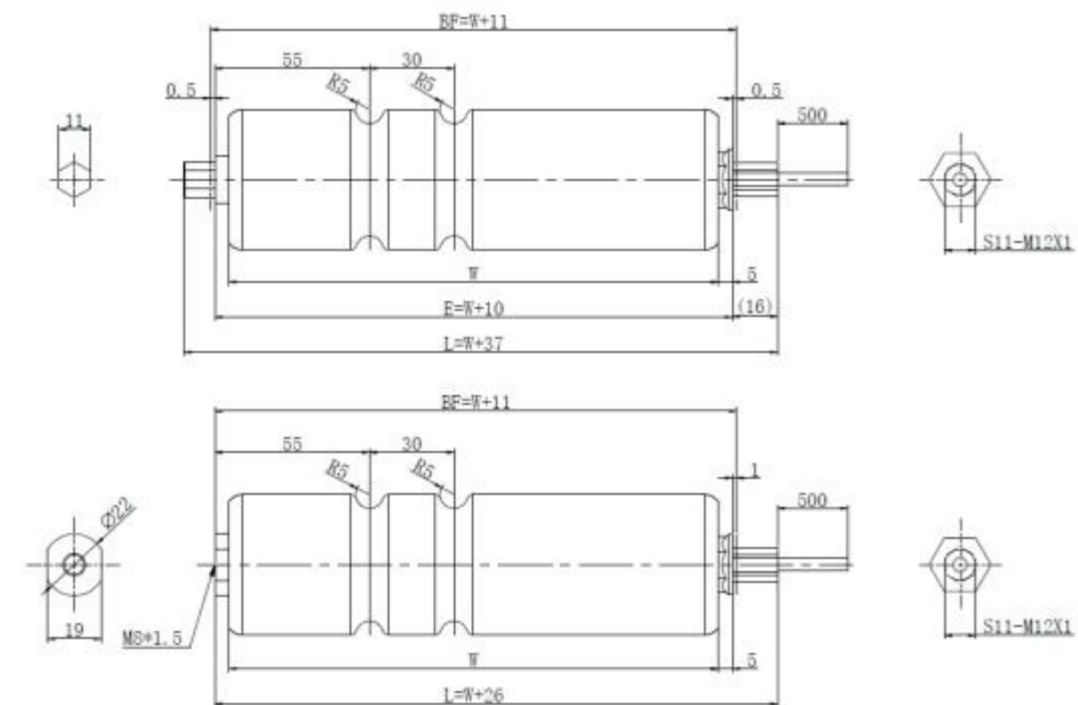

Poly-V

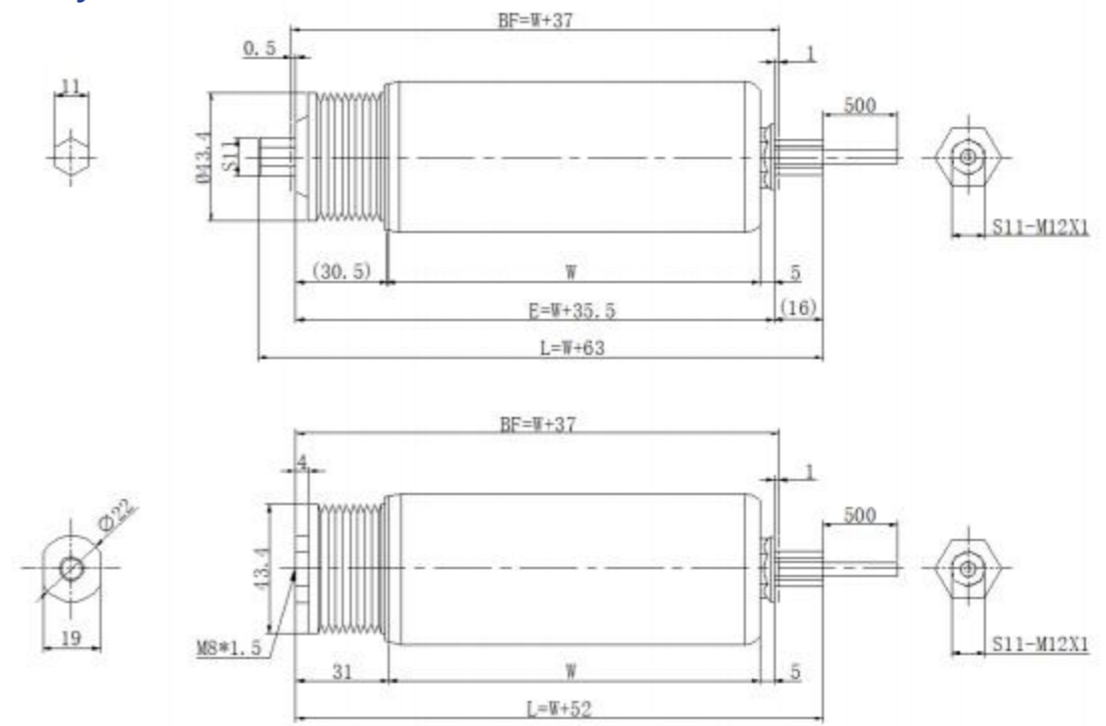

O-Belt

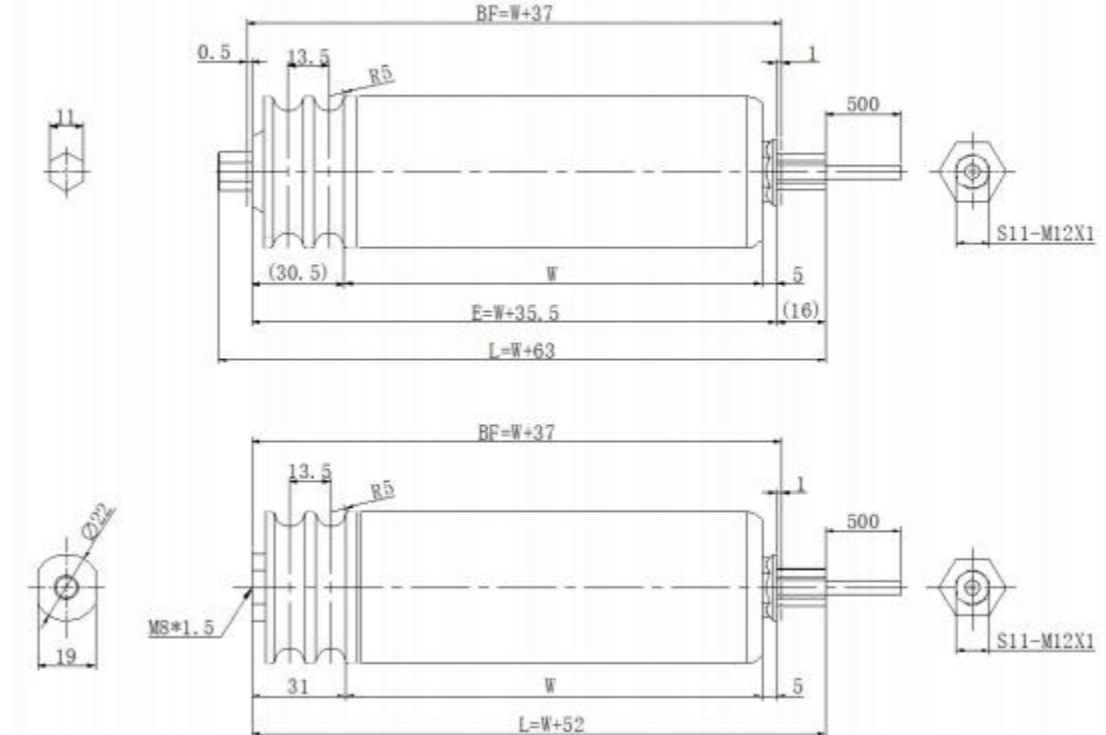

Sprocket

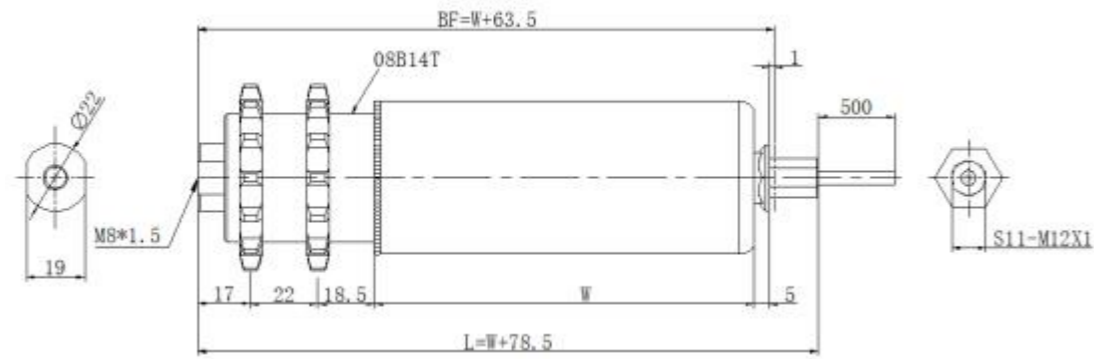

Timing Belt

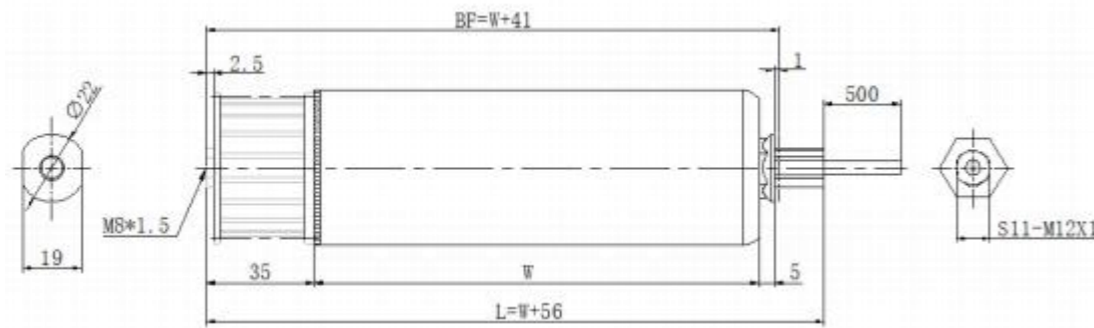

INDRIVE

Characteristics

- 7 speed real-time shifting
- 16 fixed speed settings
- Operation in forward and reverse both direction possible
- Input signal PNP/NPN adjustable
- Soft-start/-stop
- Error output concatenation

Technical Data

Rated Voltage	+24V DC voltage
Voltage Range	20V28V DC voltage
No-load Supply Current	0.4A
Rated Current	4A
Max. Peak Current	8A
Rated Power	50W
Max. Power Supply Noise Value	3%
Protection Degree	IP20
Ambient Temperature Range During Usage	0°C40°C (32F104F)
Temperature Range During Transport And Storage	-30°C+75°C (22F+167F) air humidity 5%85%

dimension

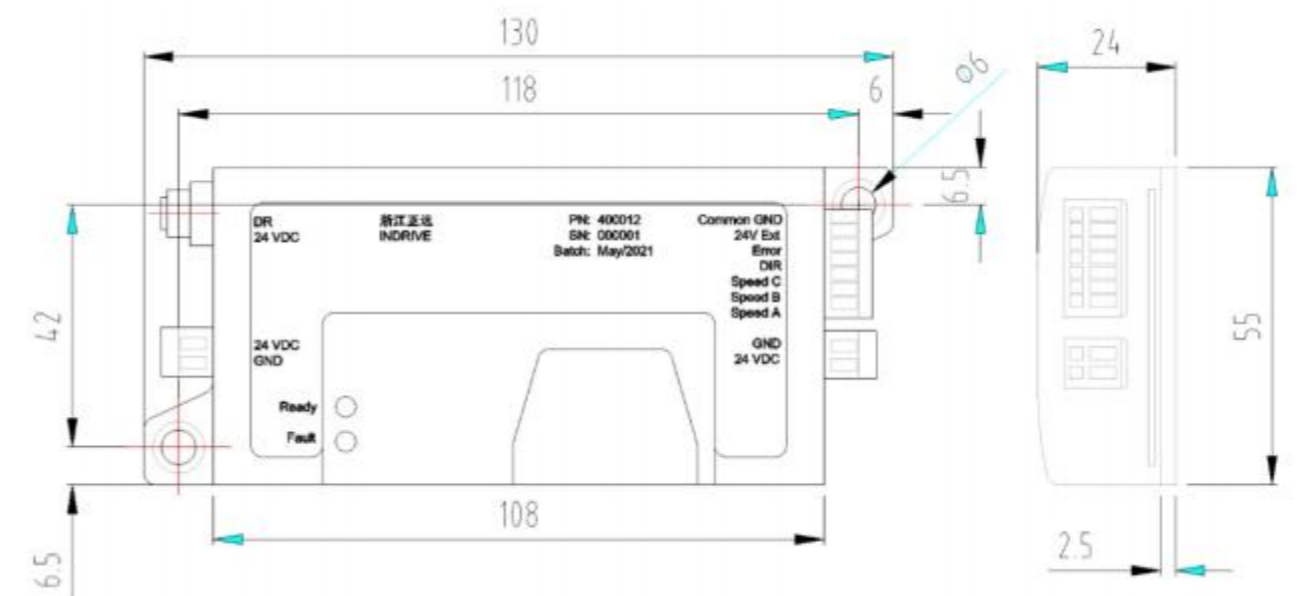

Product size

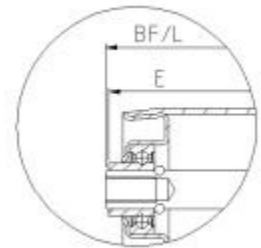
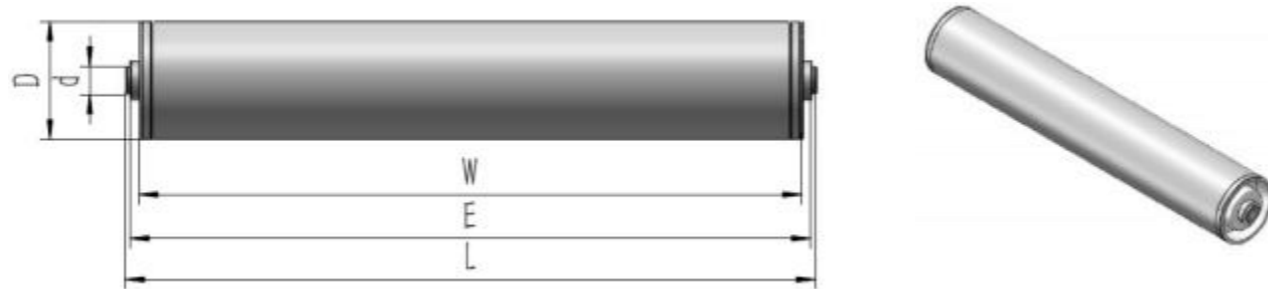

Internal Thread

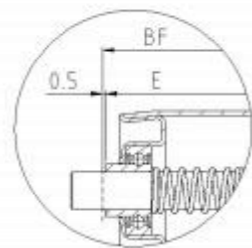

Spring Loaded

- Equipped with steel bearing housing and precision bearings, sturdy and durable
- Complete range of tube diameters available, large loading capacity
- Applicable temperatures: -30°C ~ +80°C

Specification parameter

Specifications		Tube Material		
Tube Dia. x Thickness- Shaft Dia.	Size Relations	Steel galvanized/chromed	SS 201/304	Aluminum
Φ25x1.0- 8	E=W+7	√	√	√
。 38x1.5- 12	E=W+10	√	√	
。 50x1.5- 12	E=W+10	√	√	√
。 50x1.5- 15	E=W+10	√	√	√
。 50x2.0- 12	E=W+10	√	√	
。 50x2.0- 15	E=W+10	√	√	
。 60x2.0- 12	E=W+9	√	√	√
。 60x2.0- 15	E=W+9	√	√	√
。 76x3.0- 20	E=W+9	√	√	
。 89x3.0- 20	E=W+9	√	√	
。 89x4.0- 20	E=W+9	√		

Product size

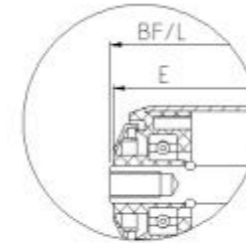
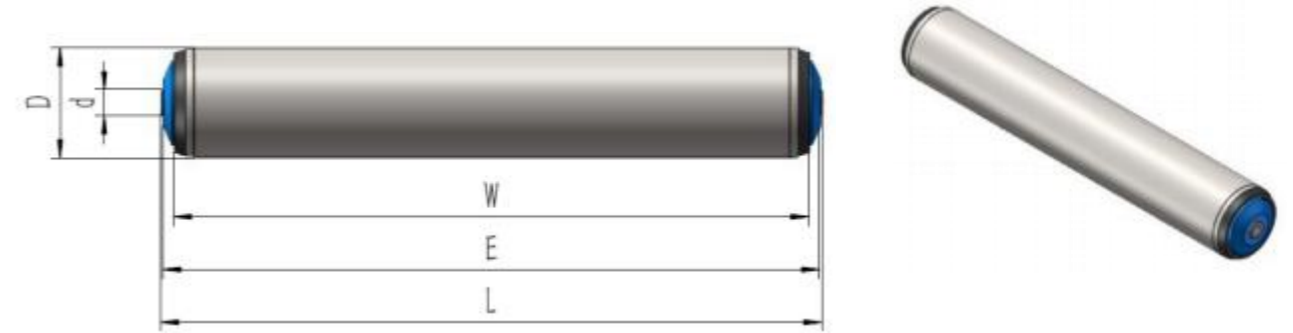

Internal Thread

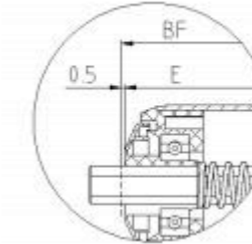

Spring Loaded

- Equipped with polymer bearing housing and precision bearings, runs quietly
- Complete range of tube diameters available, suitable for high-speed conveying
- Applicable temperatures: -5°C ~ +40°C

Specification parameter

Specifications		Tube Material		
Tube Dia. x Thickness- Shaft Dia.	Size Relations	Steel galvanized/chromed	SS 201/304	Aluminum
Φ25x1.0- 8	E=W+8	√	√	
。 38x1.5- 12	E=W+8	√	√	
。 38x1.5-11hex	E=W+8	√	√	
。 50x1.5- 12	E=W+10	√	√	√
。 50x1.5- 15	E=W+10	√	√	√
。 50x1.5-11hex	E=W+10	√	√	√
。 50x2.0- 12	E=W+10	√	√	
。 50x2.0- 15	E=W+10	√	√	
。 50x2.0-11hex	E=W+10	√	√	
。 60x1.5- 12	E=W+11	√	√	
。 60x1.5- 15	E=W+10	√	√	
。 60x1.5-11hex	E=W+11	√	√	
。 60x2.0- 12	E=W+11	√	√	
。 60x2.0- 15	E=W+10	√	√	
。 60x2.0-11hex	E=W+11	√	√	

1011/1021 Series
—Single/Double Groove O-Belt Roller with Steel Bearing Housing

Product size

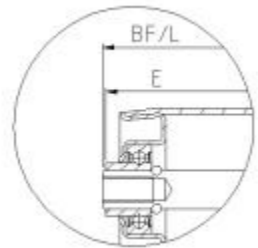
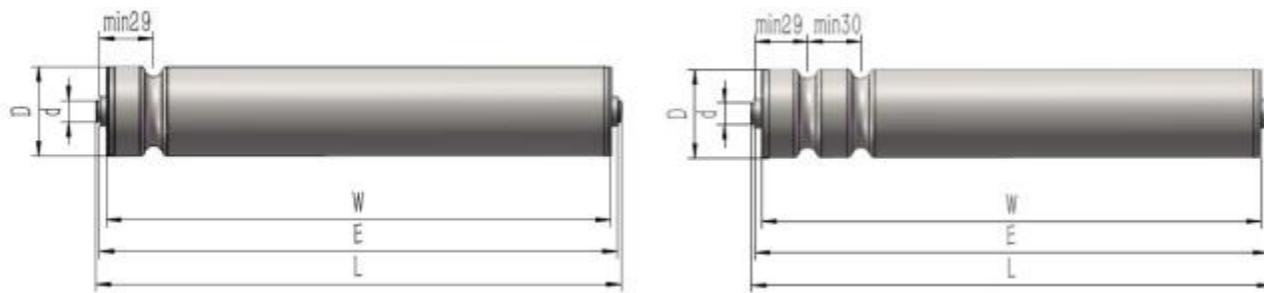

Internal Thread

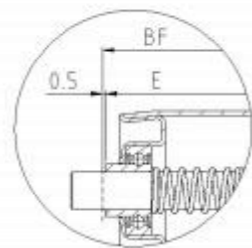

Spring Loaded

- Equipped with steel bearing housing and precision bearings, sturdy and durable
- The position of the grooves can be customized
- Applicable temperatures: -30°C ~ +80°C

Specification parameter

Specifications		Tube Material		
Tube Dia. x Thickness- Shaft Dia.	Size Relations	Steel galvanized/chromed	SS 304	Aluminum
Φ50x1.5- 12	E=W+10	√	√	
。 50x1.5- 15	E=W+10	√	√	
。 50x2.0- 12	E=W+10	√	√	
。 50x2.0- 15	E=W+10	√	√	
。 60x2.0- 12	E=W+9	√	√	
。 60x2.0- 15	E=W+9	√	√	

1012/1022 Series
—Single/Double Groove O-Belt Roller with Polymer Bearing Housing

Product size

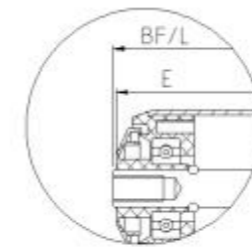
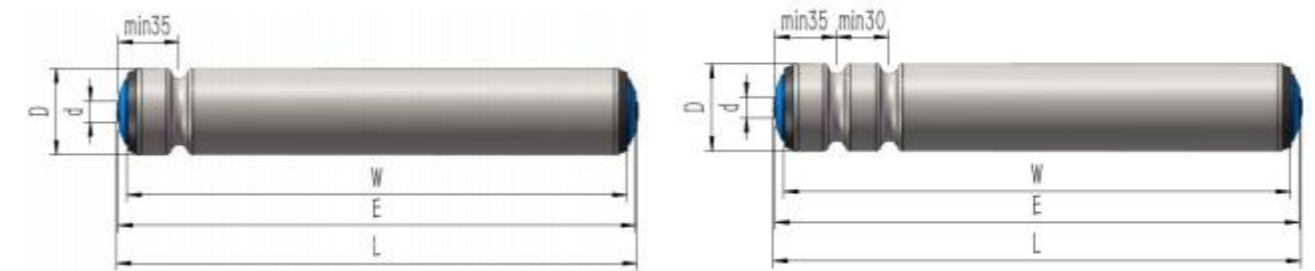

Internal Thread

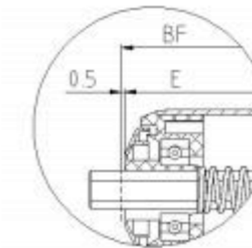

Spring Loaded

- Equipped with polymer bearing housing and precision bearings, runs quietly
- The position of the grooves can be customized
- Applicable temperatures: -5°C ~ +40°C

Specification parameter

Specifications		Tube Material		
Tube Dia. x Thickness- Shaft Dia.	Size Relations	Steel galvanized/chromed	SS 304	Aluminum
Φ50x1.5- 12	E=W+10	√	√	
。 50x1.5- 15	E=W+10	√	√	
。 50x1.5-11hex	E=W+10	√	√	
。 50x2.0- 12	E=W+10	√	√	
。 50x2.0- 15	E=W+10	√	√	
。 50x2.0-11hex	E=W+10	√	√	
。 60x1.5- 12	E=W+11	√	√	
。 60x1.5- 15	E=W+10	√	√	
。 60x1.5-11hex	E=W+11	√	√	
。 60x2.0-12	E=W+11	√	√	
。 60x2.0- 15	E=W+10	√	√	
。 60x2.0-11hex	E=W+11	√	√	

Product size

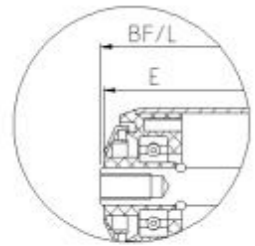
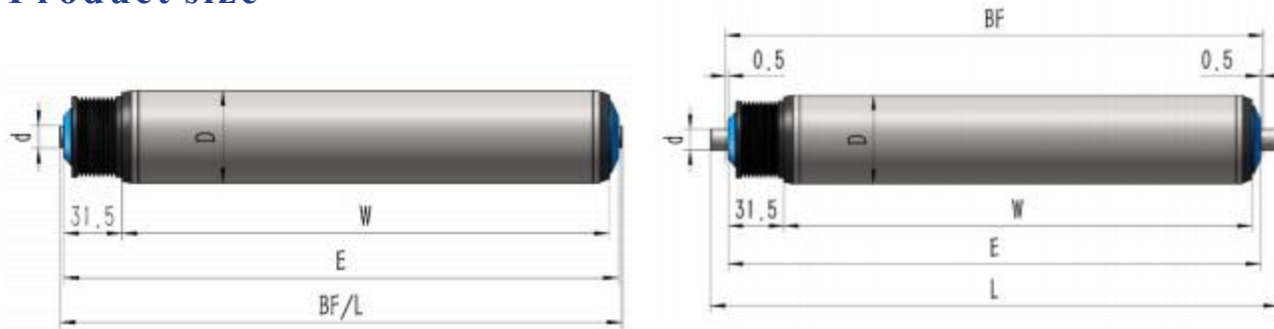

Internal Thread

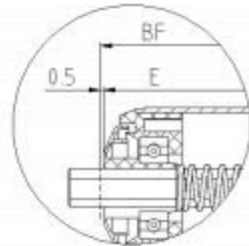

Spring Loaded

- Equipped with polymer bearing housing and precision bearings, runs quietly
 - Applicable temperatures: -5°C ~ +40°C
- Note: our department also provides steel poly-v rollers

Specification parameter

Specifications		Tube Material		
Tube Dia. x Thickness- Shaft Dia.	Size Relations	Steel galvanized/chromed	SS 201/304	Aluminum
Φ50x1.5- ϕ . 12	E=W+36.5	√	√	
ϕ . 50x1.5-11hex	E=W+36.5	√	√	

Product size

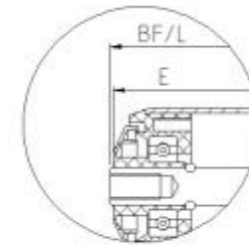
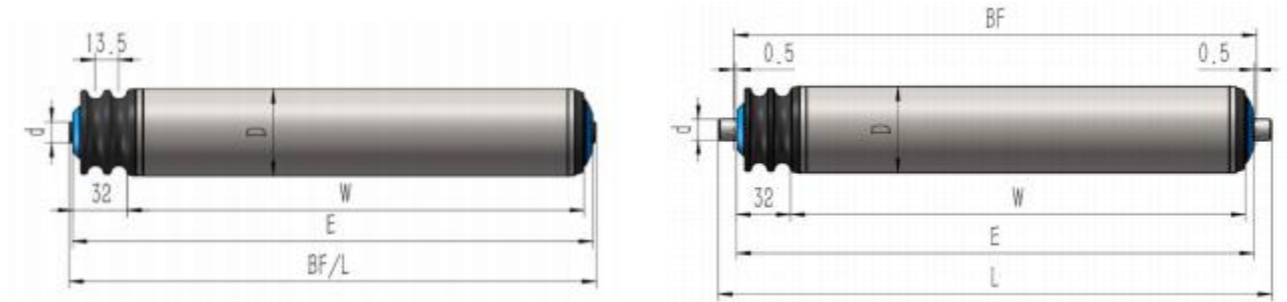

Internal Thread

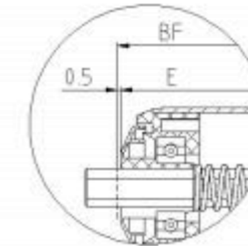

Spring Loaded

- Equipped with polymer bearing housing and precision bearings, runs quietly
- Applicable temperatures: -5°C ~ +40°C

Specification parameter

Specifications		Tube Material		
Tube Dia. x Thickness- Shaft Dia.	Size Relations	Steel galvanized/chromed	SS 201/304	Aluminum
Φ50x1.5- ϕ . 12	E=W+36.5	√	√	
ϕ . 50x1.5-11hex	E=W+36.5	√	√	

Product size

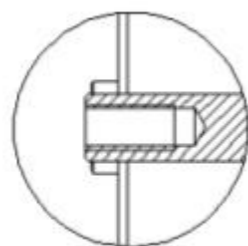
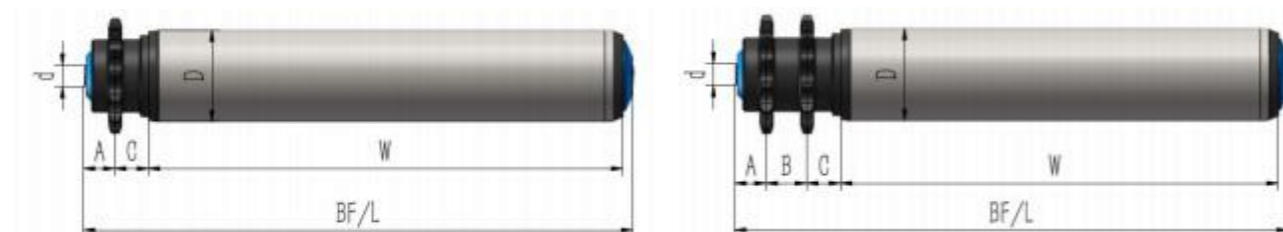

Internal Thread

- Equipped with high-performance polymer sprocket
- Precision bearings, runs quietly
- Applicable temperatures: -5°C ~ +40°C

Specification parameter

Specifications		Standard Size			Tube Material		
Tube Dia. x Thickness- Shaft Dia.	Standard Sprocket	A	B	C	Steel galvanized/chromed	SS 201/304	Aluminum
Φ50x1.5- . 12	08B14T	16.5	22	18	√	√	√
. 50x1.5- . 15	08B14T	16.5	22	18	√	√	√

Product size

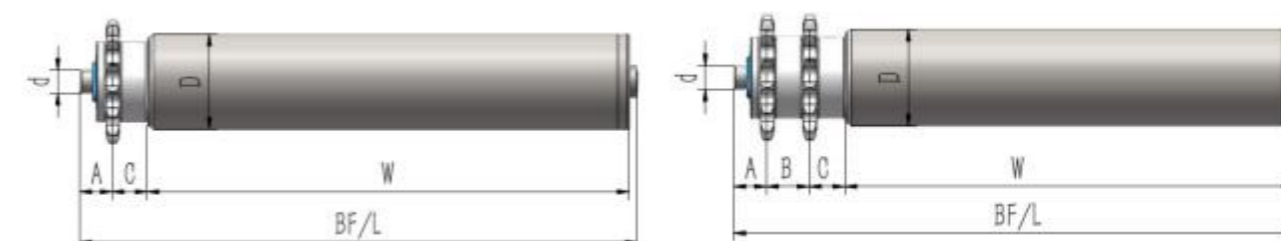

Specification parameter

Specifications		Standard Size			Tube Material	
Tube Dia. x Thickness- Shaft Dia.	Standard Sprocket	A	B	C	Steel galvanized/chromed	SS 201/304
Φ50x1.5- . 12	08B11/14T	17	22	18.5	√	√
. 50x1.5- . 15	08B14T	17	22	18.5	√	√
. 50x2.0- . 12	08B11/14T	17	22	18.5	√	√
. 50x2.0- . 15	08B14T	17	22	18.5	√	√
. 60x2.0- . 12	08B11/14T	17	22	18.5	√	√
. 60x2.0- . 15	08B14T	17	22	18.5	√	√
. 76x3.0- . 20	10A13/15T	20	25	18.5	√	√
. 89x3.0- . 20	10A13/15T	20	25	18.5	√	√
. 89x4.0- . 20	10A13/15T	20	25	18.5	√	

Product size



Internal Thread

- Equipped with steel bearing housing and precision bearings, sturdy and durable
- The size of the sprocket can be customized
- Applicable temperatures: -30°C ~ +80°C

Specification parameter

Roller OD D	Flange OD F	Flange Width H
Φ60	100	10
. 76	135	20
. 89	150	20.5

3011/3012Series
—Polymer Single/Double Sprocket Friction Accumulating Roller

Product size

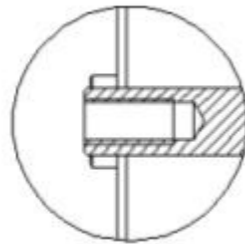
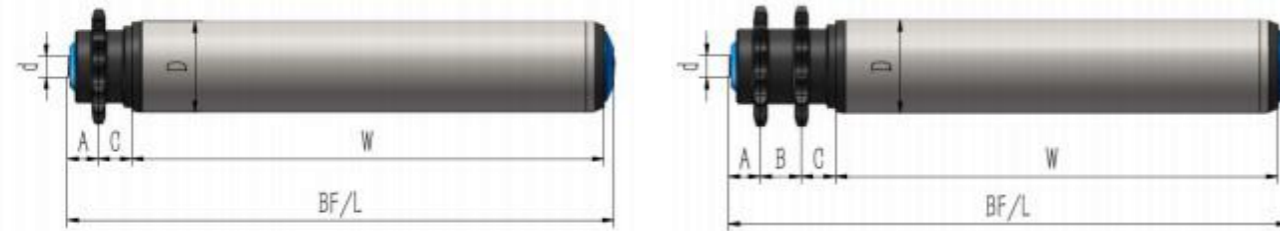

Internal Thread

- Equipped with high-performance polymer sprocket
- Precision bearings, runs quietly
- Applicable temperatures: -5°C ~ +40°C

Specification parameter

Specifications		Standard Size			Tube Material	
Tube Dia. x Thickness- Shaft Dia.	Standard Sprocket	A	B	C	Steel galvanized/chromed	SS 201/304
Φ50x1.5-φ 12	08B14T	16.5	22	18	√	√
φ 50x1.5-φ 15	08B14T	16.5	22	18	√	√

3021/3022Series
—Steel Single/Double Sprocket Friction Accumulating Roller

Product size

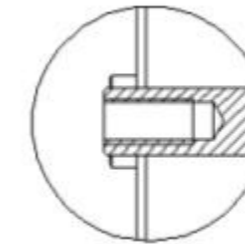
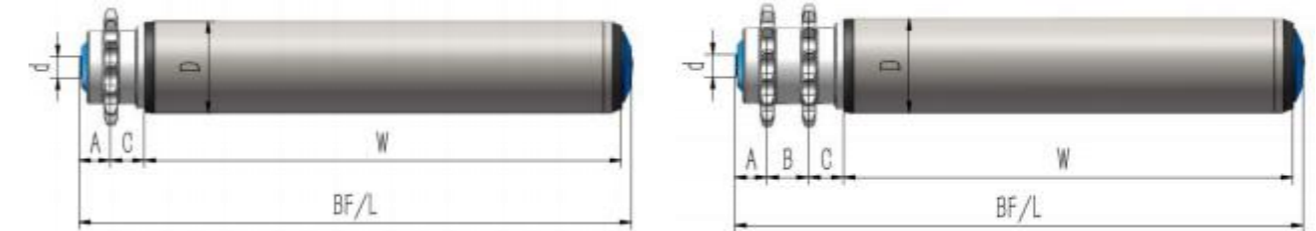

Internal Thread

- Equipped with polymer bearing housing and precision bearings, runs quietly
- The size of the sprocket can be customized
- Applicable temperatures: -5°C ~ +40°C

Specification parameter

Specifications		Standard Size			Tube Material		
Tube Dia. x Thickness- Shaft Dia.	Standard Sprocket	A	B	C	Steel galvanized/chromed	SS 201/304	Aluminum
Φ50x1.5-φ 12	08B14T	17	22	18.5	√	√	√

Product size

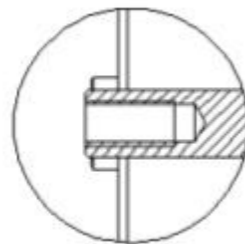
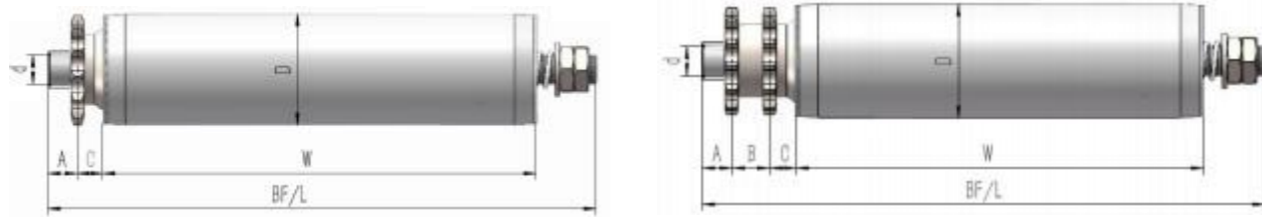

Internal Thread

- Equipped with steel bearing housing and precision bearings, sturdy and durable
- The size of the sprocket can be customized
- Friction adjustable, has a wider conveying range
- Applicable temperatures: -5°C ~ +40°C

Specification parameter

Specifications		Standard Size			Tube Material		
Tube Dia. x Thickness- Shaft Dia.	Standard Sprocket	A	B	C	Steel galvanized/chromed	SS 201/304	Aluminum
Φ50x1.5- 12	08B14T	17	22	18.5	√	√	√
。 50x1.5- 15	08B14T	17	22	18.5	√	√	√
。 50x2.0- 12	08B14T	17	22	18.5	√	√	
。 50x2.0- 15	08B14T	17	22	18.5	√	√	
。 60x2.0- 12	08B14T	17	22	18.5	√	√	
。 60x2.0- 15	08B14T	17	22	18.5	√	√	
。 76x3.0- 20	10A13T	20	25	18.5	√	√	
。 89x3.0- 20	10A13T	20	25	18.5	√	√	

Product size

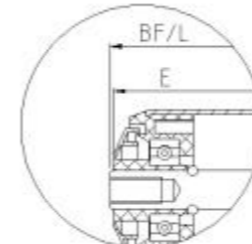
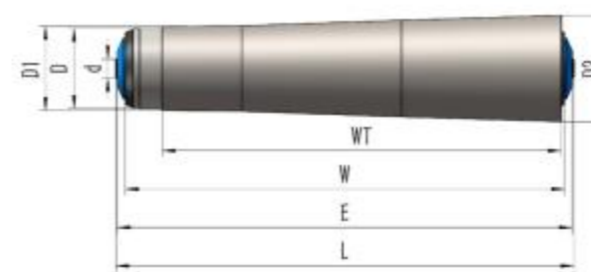

Internal Thread

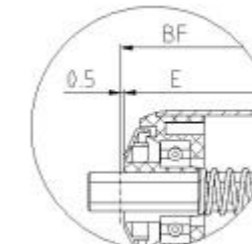

Spring Loaded

- Equipped with polymer bearing housing and precision bearings, runs quietly
- Applicable temperatures: -5°C ~ +40°C

Specification parameter

Specifications		Tapered Sleeve Size		Tube Material	
Tube Dia. x Thickness- Shaft Dia.	Standard Sprocket	WT	D1/D2	Steel galvanized/chromed	SS 201/304
Φ50x1.5- 12	E=W+10	250	52.9/68.6	√	√
		300	56/74.9	√	√
		350	52.9/74.9	√	√
		400	56/81.1	√	√
		450	52.9/81.1	√	√
		500	56/87.4	√	√
		550	52.9/87.4	√	√
		600	56/93.7	√	√
		650	52.9/93.7	√	√
		700	56/100	√	√
。 50x1.5-11hex	E=W+10	750	52.9/100	√	√
		800	56/106.3	√	√
		850	52.9/106.3	√	√
。 50x1.5- 15	E=W+10				

4012/4022Series
—Single/Double Groove O-Belt Tapered Sleeve Roller

Product size

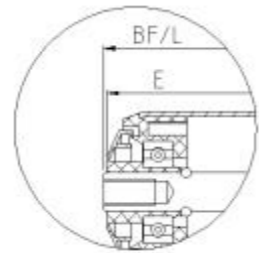
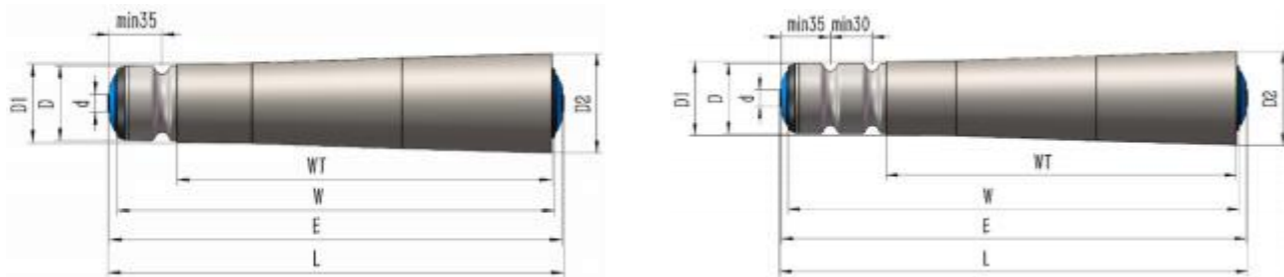

Internal Thread

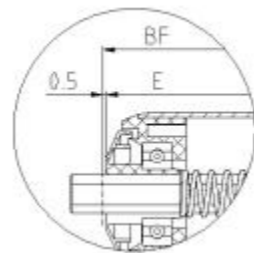

Spring Loaded

- Equipped with polymer bearing housing and precision bearings, runs quietly
- The position of the grooves can be customized
- Applicable temperatures: -5°C ~ +40°C

Specification parameter

Specifications		Tapered Sleeve Size		Tube Material		
Tube Dia. x Thickness- Shaft Dia.	Size Relations	WT	D1/D2	Steel galvanized/chromed	SS201/304	
Φ50x1.5- 12	E=W+10	250	52.9/68.6	√	√	
		300	56/74.9	√	√	
		350	52.9/74.9	√	√	
		400	56/81.1	√	√	
		450	52.9/81.1	√	√	
	E=W+10	500	56/87.4	√	√	
		E=W+10	550	52.9/87.4	√	√
			600	56/93.7	√	√
			650	52.9/93.7	√	√
			700	56/100	√	√
750	52.9/100		√	√		
E=W+10	800	56/106.3	√	√		
	850	52.9/106.3	√	√		

4034Series —Polymer Poly-V Tapered Sleeve Roller

Product size

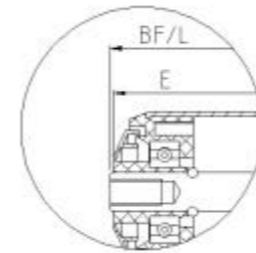
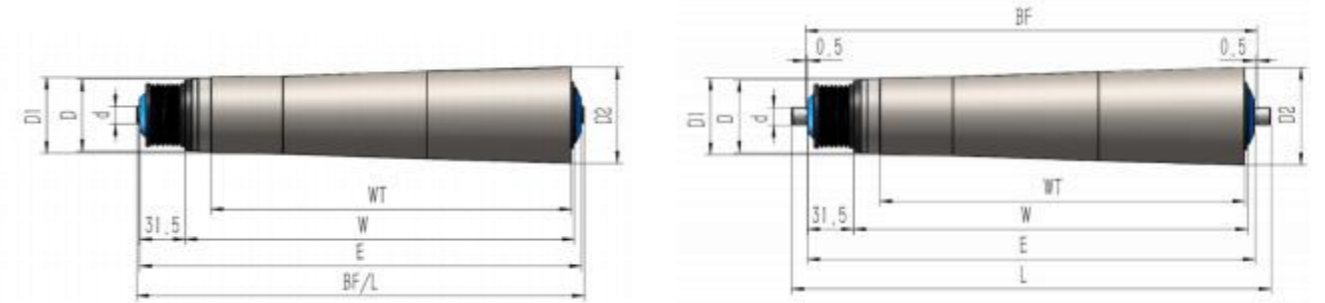

Internal Thread

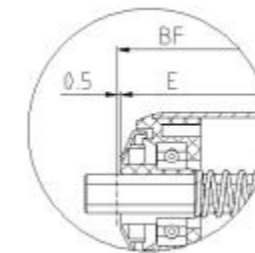

Spring Loaded

- Equipped with polymer bearing housing and precision bearings, runs quietly
- Applicable temperatures: -5°C ~ +40°C

Specification parameter

Specifications		Tapered Sleeve Size		Tube Material		
Tube Dia. x Thickness- Shaft Dia.	Size Relations	WT	D1/D2	Steel galvanized/chromed	SS201/304	
Φ50x1.5- 12	E=W+36.5	250	52.9/68.6	√	√	
		300	56/74.9	√	√	
		350	52.9/74.9	√	√	
		400	56/81.1	√	√	
		450	52.9/81.1	√	√	
	E=W+36.5	500	56/87.4	√	√	
		E=W+36.5	550	52.9/87.4	√	√
			600	56/93.7	√	√
			650	52.9/93.7	√	√
			700	56/100	√	√
750	52.9/100		√	√		
E=W+36.5	800	56/106.3	√	√		
	850	52.9/106.3	√	√		

4024Series—Polymer O-Belt Tapered Sleeve Roller

Product size

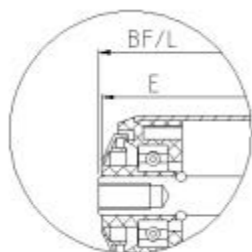
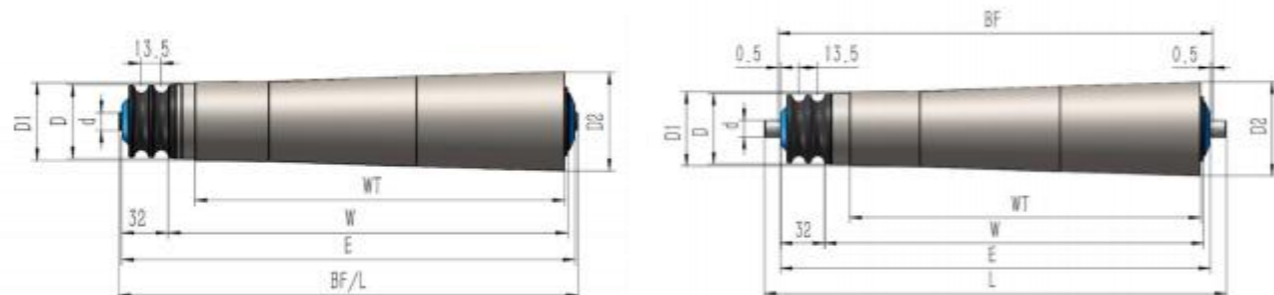

Internal Thread

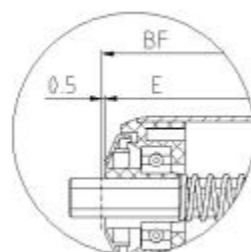

Spring Loaded

- Equipped with polymer bearing housing and precision bearings, runs quietly
- Applicable temperatures: -5°C ~ +40°C

Specification parameter

Specifications		Tapered Sleeve Size		Tube Material	
Tube Dia. x Thickness- Shaft Dia.	Size Relations	WT	D1/D2	Steel galvanized/chromed	SS201/304
Φ50x1.5- .12 .50x1.5-11hex	E=W+36.5	250	52.9/68.6	√	√
		300	56/74.9	√	√
		350	52.9/74.9	√	√
		400	56/81.1	√	√
		450	52.9/81.1	√	√
		500	56/87.4	√	√
		550	52.9/87.4	√	√
	E=W+36.5	600	56/93.7	√	√
		650	52.9/93.7	√	√
		700	56/100	√	√
		750	52.9/100	√	√
		800	56/106.3	√	√
		850	52.9/106.3	√	√

4014/4015Series —Polymer Single/Double Sprocket Tapered Sleeve Roller

Product size

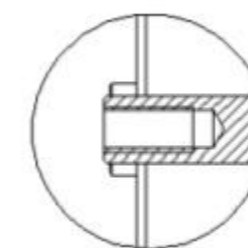
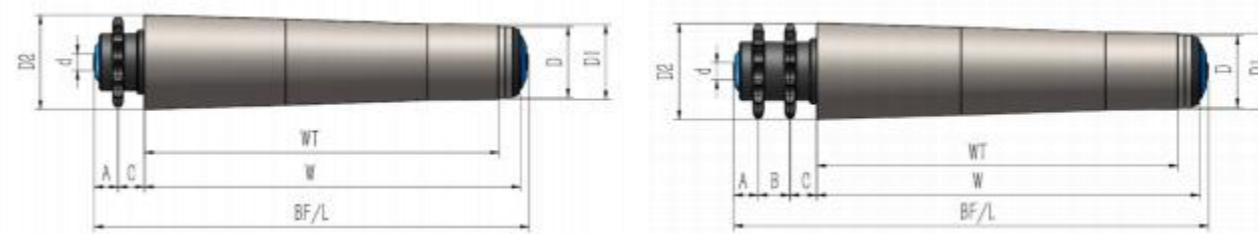

Internal Thread

- Equipped with high-performance polymer sprocket
- Precision bearings, runs quietly
- Applicable temperatures: -5°C ~ +40°C

Specification parameter

Specifications		Standard Size			Tapered Sleeve Size		Tube Material	
Tube Dia. x Thickness- Shaft Dia.	Size Relations	A	B	C	WT	D1/D2	Steel galvanized/chromed	SS201/304
Φ50x1.5- .12 .50x1.5- .15	08B14T	16.5	22	18	250	52.9/68.6	√	√
					300	56/74.9	√	√
					350	52.9/74.9	√	√
					400	56/81.1	√	√
					450	52.9/81.1	√	√
					500	56/87.4	√	√
					550	52.9/87.4	√	√
					600	56/93.7	√	√
					650	52.9/93.7	√	√
					700	56/100	√	√
					750	52.9/100	√	√
					800	56/106.3	√	√
					850	52.9/106.3	√	√

Product size

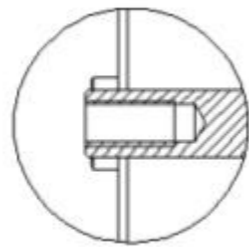
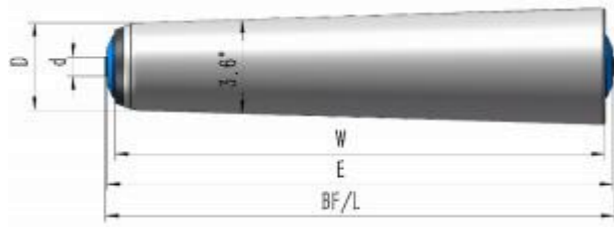

Internal Thread

- All steel tube, sturdy and durable
- The size can be customized
- Applicable temperatures: -5°C~+40°C

4004/4005Series —Steel Single/Double Sprocket Tapered Roller

Product size

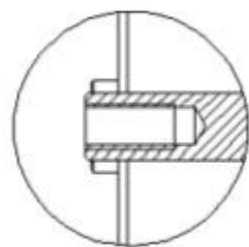
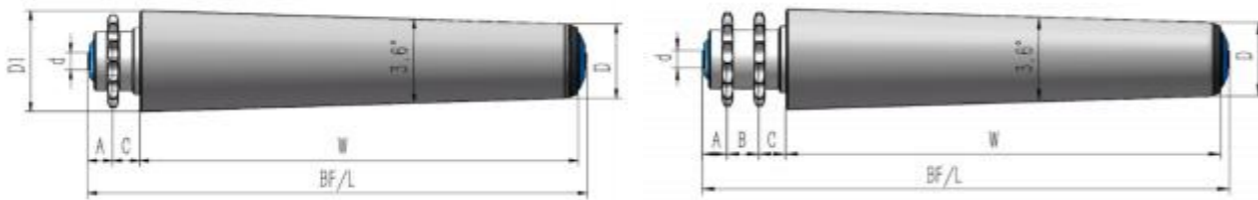

Internal Thread

- All steel tube, sturdy and durable
- The size can be customized
- Applicable temperatures: -5°C~+40°C

5001Series

Fixed Shaft Roller

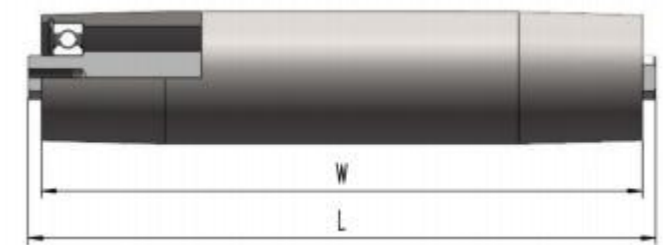

5002Series

Rotating Shaft Roller



5003Series

Tapered Belt Conveyor Roller



- 5001、5002 series applicable for linear belt conveyor, 5003 series applicable for curved belt conveyor
- All steel tube, sturdy and durable
- The size can be customized
- Applicable temperatures: -30°C~+80°C